

Art.-Nr.: **24217x**  
item#

## Navi Chevrolet Orlando ab 03/2011

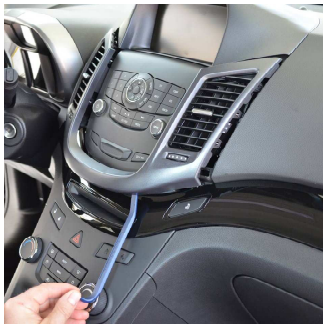

Verkleidung aushebeln  
Bitte benutzen Sie nur ein Kunststoff-Werkzeug!



Remove covering  
Please use only plastic tools!

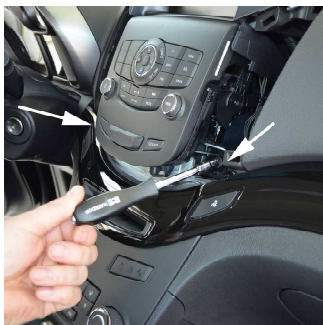

Originalschrauben lösen



Unscrew original screws



Radio vorziehen



Pull radio forward



Originalschraube lösen



Loosen original screw



Verkleidung aushebeln  
Konsole wie abgebildet einschieben, hinteres  
Blech umbiegen



Remove covering  
Insert console as illustrated, bend rear metal plate





Änderungen vorbehalten Subject to change

Art. 24217x

## Navi Chevrolet Orlando ab 03/2011



 Tirez la couverture  
Veuillez n'utiliser qu'un outil de matière plastique

 Suelte el revestimiento  
Use sólo herramientas de plástico!

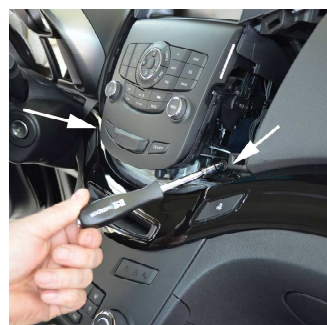

 Desserrez les vis originales

 Suelte los tornillos originales



 Avancez l'autoradio

 Tire la radio hacia delante



 Desserrez la vis originale

 Suelte los tornillos originales

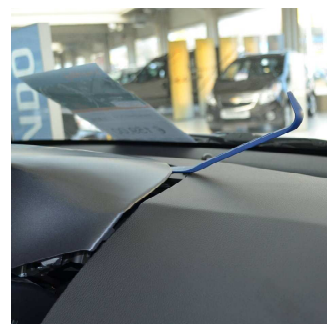

 Tirez la couverture  
Inserez la console comme illustré, tordez la tôle  
arrière

 Suelte el revestimiento  
Introduzca la consola como mostrado, tuerza la  
chapa trasera



Art. **24217x**

## Navi Chevrolet Orlando ab 03/2011



Bekleding uitnemen  
Alleen plastic gereedschap gebruiken alstublieft!



Wywazyc tapicerke  
Prosze uzywac tylko narzedzi z tworzywa sztucznego.

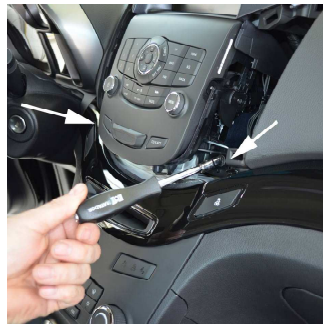

Originele schroefen losdraaien



Poluzowac oryginalna srubes



Radio naar voren trekken



Wyciagnac radio



Suelte los tornillos originales



Poluzowac oryginalna srubke



Bekleding uitnemen  
Console zoals afgebeeld inschuiven, achterste metalen plaat ombuigen



Wywazyc tapicerke  
Wsadzic konsolle jak na zdjeciu i zagiac tylna blaszke



Nous nous réservons la possibilité de modification Salvo posibles modificaciones